

Alice L. Pendleton Library

Sustainable Libraries Initiative Certification Program

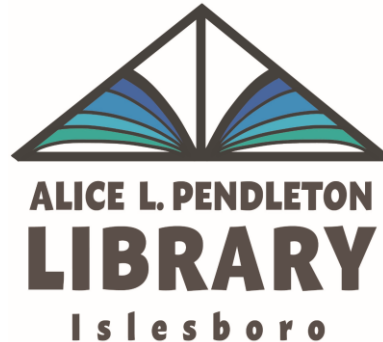

Alice L. Pendleton Library

Islesboro, Maine



- Located on Islesboro, a small island off mid-coast Maine, which is accessible by a fifteen minute ferry ride.
- Main library built in 1918, 1993 addition.
- Municipal
 - Town manager
 - Trustees (advisory)
 - Friends (not-for-profit)

Section A. Getting Started

Sustainable Libraries Certification Program
presented and approved *immediately* by
ALP Library:

- Staff
- Trustees
- Friends (501c3)
- Town manager
- Selectboard

Second Generation Lead Team: director
Melissa Olson, Trustee chair Brooke Hua,
Trustee Susan West and Cressica Brazier,
PhD., Islesboro Energy Committee



Section B. Outdoor Spaces

- Full revamp of Remembrance Garden
 - Removal of invasive species
 - More native plants
 - Inclusion of pollinator garden
 - More seating
- Only public garden on Islesboro

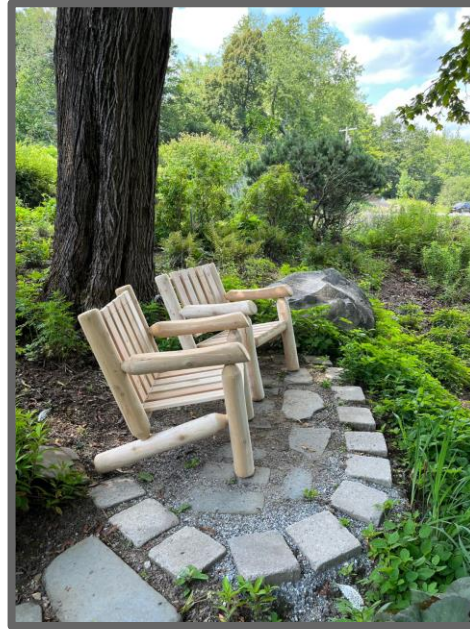

MEMBER SPOTLIGHT

Name: Alice L. Pendelton Library

Location: Islesboro, Maine

Membership: SLCP Public Library



Taking advantage of its beautiful outdoor spaces, Alice L. Pendleton Library utilizes the space for good: bringing environmentally, socially, and financially sustainable practices to the surrounding community with a variety of gardens and programming.

Stormwater runoff is well taken care of on library grounds. A gravel parking lot, rain barrels, well drained roof runoff, and brick walkways inlaid with porous material allow precipitation to infiltrate the ground on every inch of library property, ensuring replenishment of the underlying aquifer and avoiding the transportation of contaminants from human activity into the surrounding sea.

The library also prides itself on its two well-kept gardens: a Children's Garden that is also used as an activity space, and their Remembrance Garden, the only public garden in Islesboro, where community members can contribute memorials to loved ones and enjoy the peaceful outdoors.



"The benefits of the action items in this section to the library have been huge. Our Remembrance Garden was overgrown, not very welcoming, and included invasive species. Now it's completely redesigned, by a professional garden landscaper and community member, and includes more open spaces, clear walking paths, more seating, more native plants and no invasive species. The library would not have undertaken this wonderful project without undertaking the SLCP," said Library Director Melissa Olsen.

The library's gardens, taken care of largely by the Friends of Alice L. Pendleton Library, are biocide free and are maintained by pulling weeds, hand-watering, and mowing larger areas.

The Children's Garden is often utilized for programming. Some programs conducted in the space include a petting zoo, pumpkin carving, and outdoor movies.



Have a great idea you're proud of? Fill out the form linked below to submit your idea for future editions of the newsletter!

Section C. Indoor Spaces

- Lots of natural sunlight
- Working fireplace!
- Designated spaces for YA and MakerSpace



Section D. Transportation

- Bike rack made by Bicycle Safety Committee
- Bike repair kit at circulation desk
- “Carpool if you can” on all event flyers

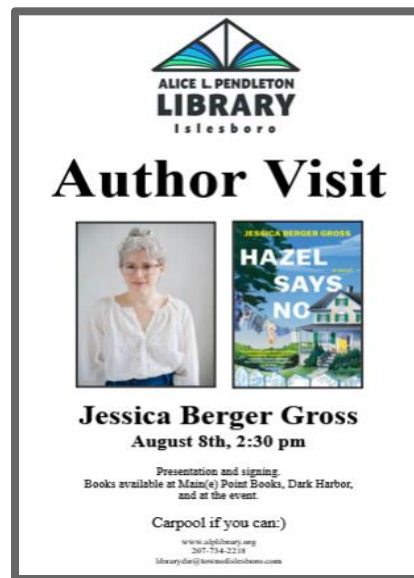

Section E. Energy

- Installed LED light fixtures
- Installed solar panels
- Installed heat pumps
- 2027 goal of Net-Zero



Section F. Water

- Most water used to water garden
- Redesigned garden includes more native, water resilient plants
- Rain water collected to water garden

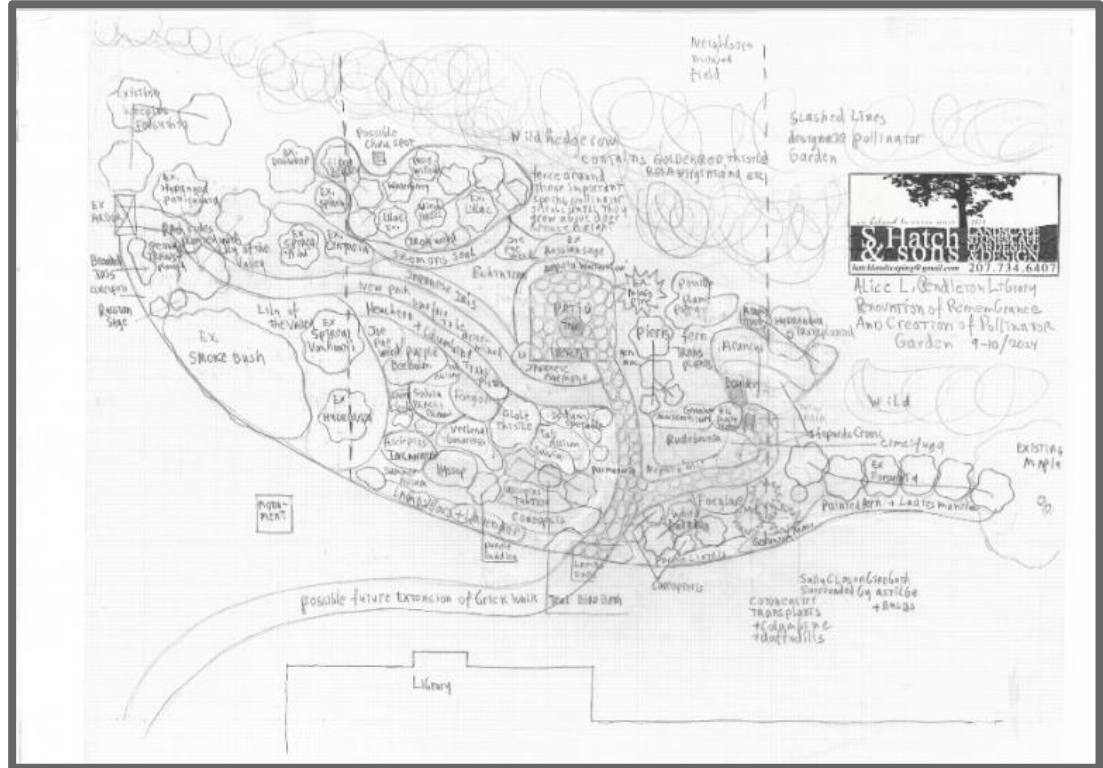

Section G. Materials

- Paper products bought in bulk
- After-school programs composting
- Reusable library bags
- Communal beverage carafes
- Reusable mugs
- USDA Certified Biobased cleaning products
- Free-trade tea and coffee



Section H. Collective Impact

- Participated in community center's farmers' market
- Hosted community leaders' meeting on island issues
- Created QR code to ALPLibrary collections catalog, which was placed at Islesboro Central School
- Partnered with island bookstore to host author visits



Section I. Social Cohesion

- Coordinated Pen Pals between Kindergarten/First grade classroom and the Sewing Circle
- Hosted Ukranian egg decorating workshop March of 2020
- Built and placed four Little Free Libraries around the island (decorated by high school art students)

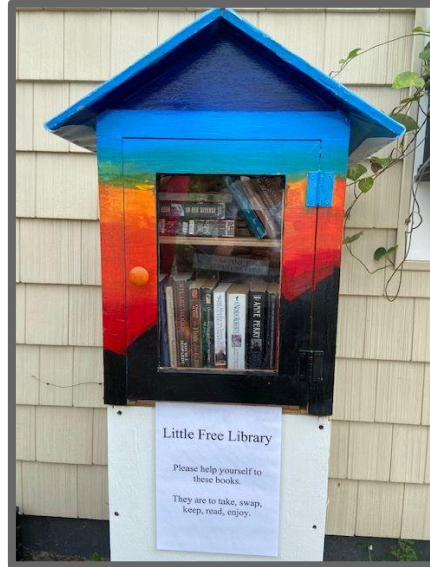

Section J. Resilience Planning

- Created outdoor Children's Garden during COVID pandemic
- Designed Geocaches, Library Style
 - Partnership with local conservation organization
 - Outdoors/Nature
 - Technology skills
 - Library skills



Alice L. Pendleton Library

Name:

Geocache Hunt 2021
"Nature Exploration"



Using a smart phone or GPS device and Google Maps:
 1. Go to the IIT trail,
 2. Follow the coordinates,
 3. Find the geocache (small square clear plastic box),
 4. Write down the title and call number of the book,
 5. Come to the ALP Library,
 6. Find the book in the Junior section downstairs,
 7. Take a sticker from the book and put it in your booklet.



IIT TRAIL	COORDINATES	TITLE OF BOOK	CALL NUMBER	STICKER
Turtle Head	44.3964760, -68.8797635 44.3830825, -68.8802456			
Huckle Preserve	44.3802343, -68.8713172			
Blueberry Hill Preserve	44.3189752, -68.8748413 44.3800813, -68.8796110			
Herbert Preserve	44.3412584, -68.8939331 44.3428355, -68.8971161			
The Meadows	44.3145882, -68.9015739			
Broad Point Preserve	44.2848836, -68.9260631 44.2877246, -68.9233343			

Section K. Financial Sustainability

- Municipally-funded
- Friends of the ALP Library 501c3
 - Purchased solar array
 - Maintains Remembrance Garden
 - Pays for Kanopy and Cloud Library
 - Provides authors honoraria
- Book and bake sales
 - Popular community events that raise money, repurpose books and result in increased goodwill and support.



Section L. Collections

- Celebrate DEI monthly
- Repurposed spaces by *weeding*.
 - Created meeting room for large gatherings
 - Created YA room



Further Goals:

- Net-Zero by 2027
- Increased visitation of underrepresented populations through board membership and programming.
- Design Childrens' Garden
 - Vegetable garden
 - Fruit bushes
 - Seating

Contact info:

librarydir@townofislesboro.com

207-734-2218

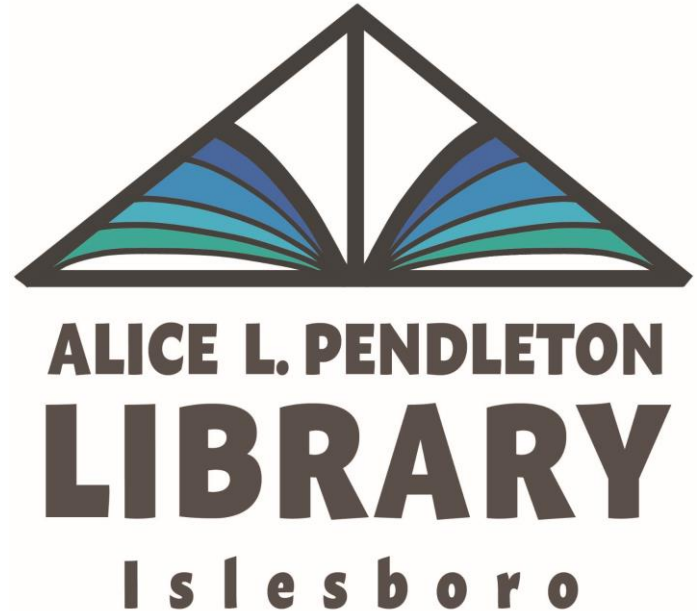

<https://www.alplibrary.org/>